

WatchBP Office

**Microlife WatchBP Office,
guidelines based
professional blood pressure
monitors**





AFIB detection

Screens for atrial fibrillation during blood pressure measurement.



3 consecutive measurements

For accurate blood pressure measurement and better Afib detection.



ABI assessment

Fast, easy and reliable simultaneous ankle-arm blood pressure measurement for screening of peripheral arterial disease.



PC link

Transmit all measurement data to PC via USB connection.

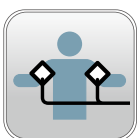

Double arm measurement

Unique dual-cuff design for assessing inter-arm blood pressure differences.



Central blood pressure measurement

Non-invasive, reliable method based on brachial pulse volume plethysmography (PVP) waveforms.



Auscultatory mode

For use in e.g. elderly, obese and those with arrhythmia.



WatchBP Office Afib

WatchBP Office Afib

Dual-cuff blood pressure monitor with atrial fibrillation detection and auscultatory measurement function.



WatchBP Office ABI

WatchBP Office ABI

Cardiovascular Screening Device, Dual-cuff blood pressure monitor with atrial fibrillation detection and Ankle-Brachial Index function.



WatchBP Office Central

WatchBP Office Central

Cardiovascular Screening Solution, Dual-cuff blood pressure monitor with atrial fibrillation detection, Ankle-Brachial Index assessment and central blood pressure measurement function.

Screen for AFIB & IAD A leading risk factor for stroke



WatchBP Office Afib

AFIB detection

3 consecutive measurements

Double arm measurement

Auscultatory mode

PC link

- ✓ Atrial fibrillation (AFIB) detection.
- ✓ Dual-cuff design for simultaneous measurement on both arms to assess the Inter-Arm Difference (IAD).
- ✓ Auscultatory mode, for use in e.g. elderly, obese and those with arrhythmia.
- ✓ Software CD included, and can also be downloaded from the website: www.watchbp.com



Atrial fibrillation detection

WatchBP AFIB detects atrial fibrillation with high accuracy (sensitivity 97-100% - specificity 89%) as demonstrated in multiple comparative studies with ECG.

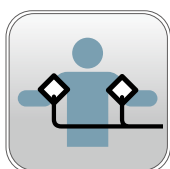

The most reliable tool for determining inter-arm blood pressure differences

Inter-arm difference (IAD) in blood pressure is an important cardiovascular risk predictor. Therefore, blood pressure must be measured in both arms at the first clinical visit.

IAD Threshold	
Diastolic ≥ 10mmHg	Systolic ≥ 20mmHg



Operation Mode:

Mode	Measurements	Interval time	AFIB detection	Double arm measurement	PC link
Routine	3	15" default 30"/45"/60" selectable	●	-	●
Auscult	1	-	-	-	-
Screen	3	15" default 30"/45"/60" selectable	●	●	●





WatchBP Office ABI

Cardiovascular Screening Device



AFIB detection



3 consecutive measurements



Double arm measurement



ABI assessment



PC link

- ✓ Fast, easy and accurate Ankle Brachial Index (ABI) assessment.
- ✓ Atrial fibrillation (AFIB) detection.
- ✓ Dual-cuff design for simultaneous measurement on both arms to assess the Inter-Arm-Difference (IAD).
- ✓ Software CD included, and can also be downloaded from the website:
www.watchbp.com

Ankle brachial index assessment : screening for peripheral arterial disease

Presentation of the measurement results

On the device

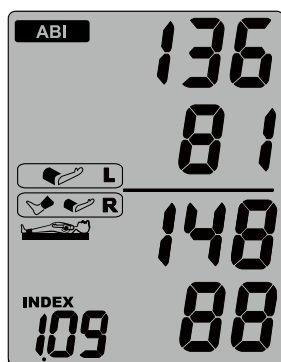

On the PC

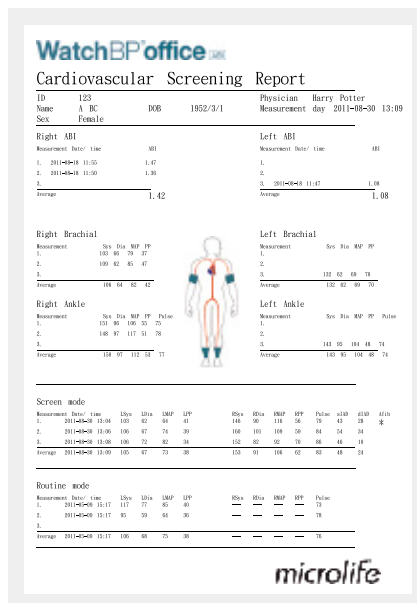
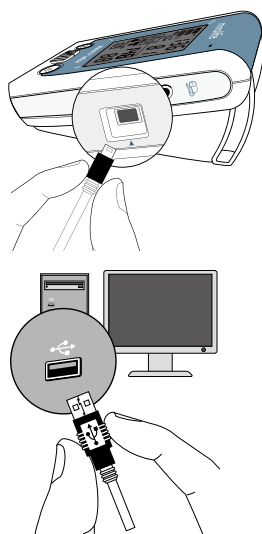

Operation Mode:

Mode	Measurements	Interval time	ABI assessment	AFIB detection	Double arm measurement	PC link
ABI	1	-	●	-	-	●
Routine	3	15" default 30"/45"/60" selectable	-	●	-	●
Screen	3	15" default 30"/45"/60" selectable	-	●	●	●





WatchBP Office Central

Cardiovascular Screening Solution



AFIB detection



3 consecutive measurements



Double arm measurement



ABI assessment



PC link



Central Blood pressure measurement

- ✓ Non-invasive central blood pressure measurement.
- ✓ Fast, easy and accurate Ankle Brachial Index (ABI) assessment.
- ✓ Atrial fibrillation (AFIB) detection.
- ✓ Dual-cuff design for simultaneous measurement on both arms to assess the Inter-Arm-Difference(IAD).

Central blood pressure

Central blood pressure is the pressure in the aorta, the largest artery that originates from the heart. Central blood pressure measurement may better correlate with cardiovascular risk than upper arm blood pressure measurement because the aorta is more close to the heart and brain, the most vital organs of the body.

The WatchBP Office Central has surpassed all requirements of the international standards



The aorta distributes oxygenated blood to all parts of the body.

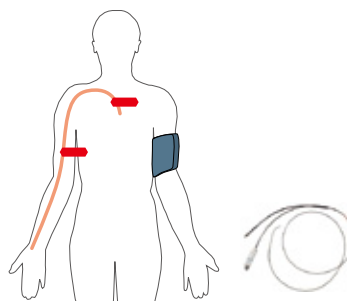

The WatchBP Office Central has been validated against intra-arterial blood pressure measurement.



Operation Mode:

Mode	Measurements	Interval time	Central BP measurement	AFIB detection	Double arm measurement	PC link	ABI assessment
ABI	1	-	-	-	-	●	●
Central	2	15" default 30"/45"/60" selectable	●	-	-	●	-
Screen	3	15" default 30"/45"/60" selectable	-	●	●	●	-

